







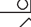

Jupiter Room

-  Chandelier Light Point
-  Spotlight
-  Switched Socket
-  Master Lighting Control
-  Light Switch
-  Dimmer Light Switch
-  TV Aerial
-  ISDN Point
-  Fire Exit (to be kept clear)
-  Ceiling Speaker

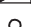

Capacities

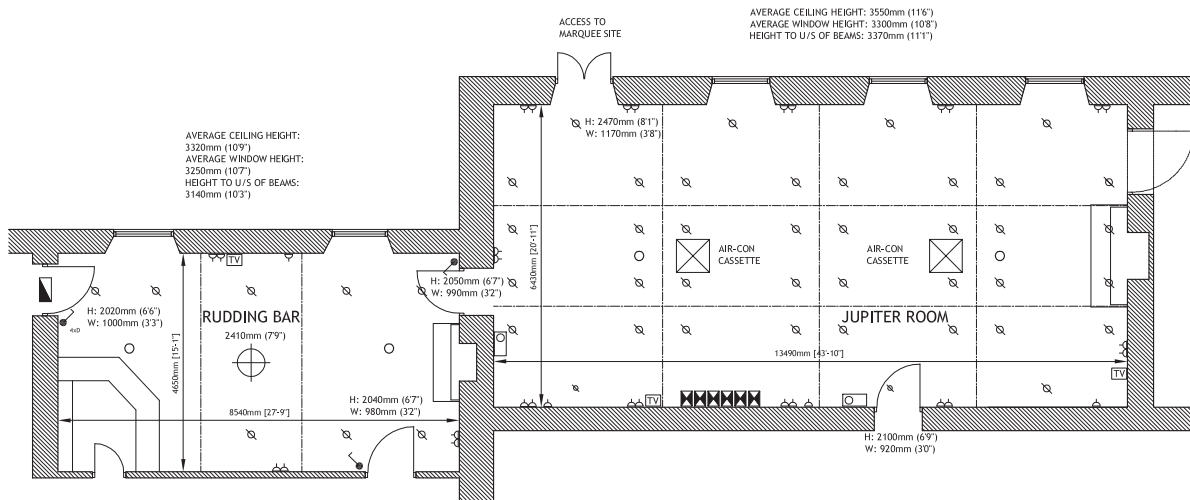
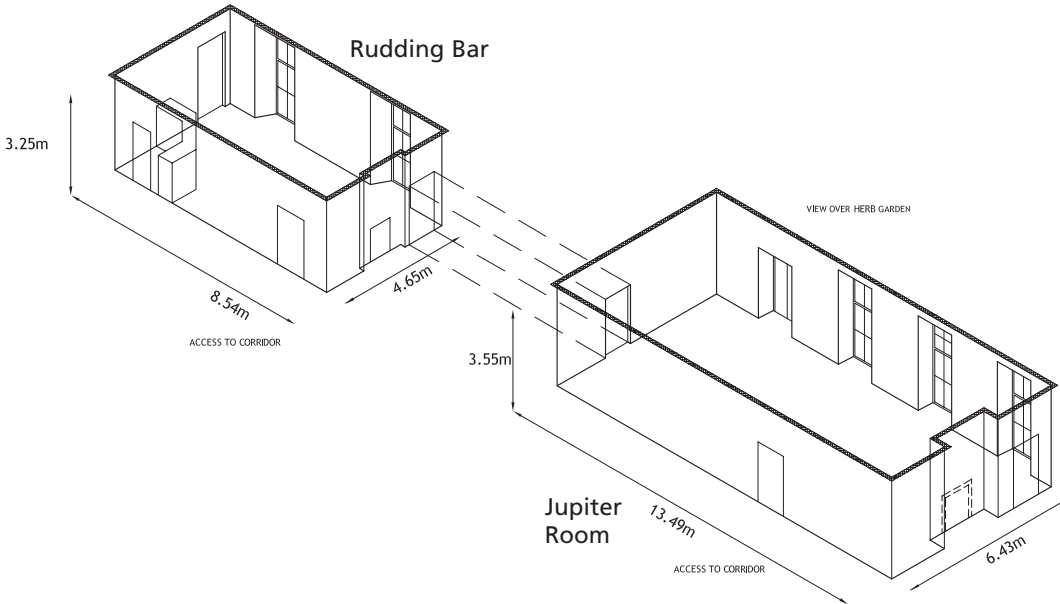
Measurements	Length	Width	Ceiling Height	Theatre Style	Classroom Style	Banqueting Style	Dinner Dance	Reception
Jupiter Room	13.4m (44')	6.3m (21')	3.6m (12')	80	36	60	-	80
Ridding Bar	8.7m (29')	4.5m (14')	3.7m (12')	30	-	12	-	30